

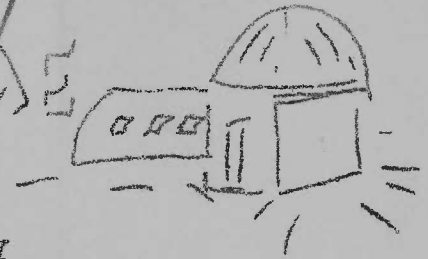

January 1964 THE DOUBLE DOME



Issued by the
MILWAUKEE ASTRONOMICAL SOCIETY

January 17, 1964, our monthly meeting - 7:45 P.M.
(we would like to remind our many new members to
reserve every third Friday of the month for MAS)

We meet at the Kilbourn Avenue entrance of the new Museum
lecture hall.

Our speaker for this evening will be Dr. Charles Cowley
from Yerkes Observatory. He will talk on astronomical
discoveries.

The winter 1963 issue of LORE, the official magazine
of the Public Museum membership "Friends of the Museum, Inc."
contains a story called The Star of Bethlehem, by Herbert
W. Cornell, one of our founder members.

Lost & Found Dept. At our last meeting the wrong blue
stocking cap was taken. Whoever took it must have found out
by now that it is the wrong size for him, so will he please
bring it to our next meeting and exchange with the other
blue stocking cap owner?

For Sale Dept. Donald Haaya of 3578 N. 10 St. CO4-0918
has a 6-inch reflecting telescope for sale for \$100.
Frank Vaughn optics, 1/20th wave primary mirror, solid
equatorial mounting, 1-3/4" shafts.

We will be a thrifty group this year by inserting a page
of changes to the membership directory and labelling it the
1964 directory. These will be distributed at the January
meeting. If you already have a directory you can just take
the extra sheet with you and insert it in your copy.

If you have an item of information which you would like
to include in the DOUBLE DOME, please send it to the secretary,
Mrs. Carolyn Kliman at least ten days before our regular
meeting.



Feb 1964 THE DOUBLE DOME

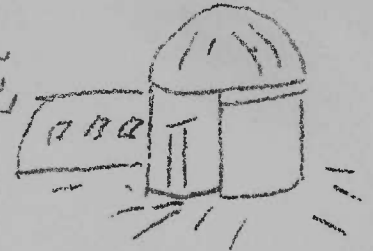

Issued by the
MILWAUKEE ASTRONOMICAL SOCIETY

Our monthly meeting will be on Friday, February 21, 1964
at 7:45 P.M. in the new museum bldg., Kilbourn Av. entrance

One of our members, Arpad Elo, well-known to most of
us, will speak on new instrumentation in spectroscopy.

* * *

News: The new well at our observatory has been completed
to 172 feet. There is good water 70 feet from the surface.
The next phase of this project concerns the installation
of a pump, a tank, and septic tank. The Board of Directors
will meet on Feb. 14th to discuss this matter.

The Vocational School channel 10 will present on its Science
Reporter program the following:

Tues. Feb. 18 at 7:30 P.M. Center of the Universe
In the projection room of the Massachusetts
Institute of Technology Library, Dr. Harlow
Shapley, world-renowned astronomer and emeri-
tus director of the Harvard Observatory, de-
scribes the heavens and his concept of the origin
of the universe and earth's position in it.

* * *

March 1964

THE DOUBLE DOME

Issued by the

MILWAUKEE ASTRONOMICAL SOCIETY

Our monthly meeting is on Friday, March 20, 1964 in the lecture hall of the new museum, Kilbourn av. entrance. 7:45 P.M.

Mr. Michael Petrlik, jr., instructor of astronomy at UWM, will give a talk on "Cosmological Theories and the Extent of the Universe"

* * *

This year's Blanche Yale memorial lecture will be presented by the Milwaukee Public Museum on Wednesday, April 29th at 8:00 P.M. in the new lecture hall. The speaker will be the noted geologist, Dr. Richard J. Anderson of the Batelle Memorial Institute in Columbus, Ohio, and his talk will be "Lunar Landscape". This will be followed by a reception for Dr. Anderson, and a chance to view the new moon exhibit on the first floor. M&S members are invited to attend.

* * *

A map of Racine and further information on the convention of the North Central Region to be held Saturday, May 16th can be had by those interested in attending this convention by calling the secretary at HI5-6765, or by asking for it at our March 20th meeting. The 16" telescope at the Modine Bonstead Observatory will be open to guests Friday night of May 15th and on Saturday after the banquet.

April 1964

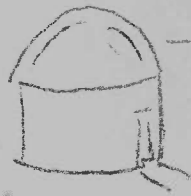

THE DOUBLE DONE

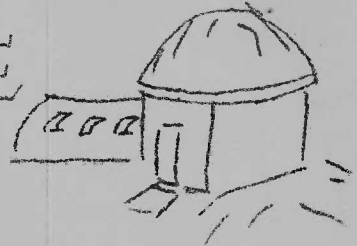

Issued by the

MILWAUKEE ASTRONOMICAL SOCIETY

Monthly meeting: Friday, April 17, 1964 at 7:45 P.M.
Place: New museum lecture hall, Kilbourn av. entrance

Speaker: Dr. J. Allen Hynek, director of Dearborn Observatory
His subject: A Lunar Observatory

* * *

A reminder - Attend the North Central Region convention in Racine on Saturday, May 16 -- a good way for some of us to get the "feel" of how a meeting like this is run - thus preparing ourselves for our own duties in the 1965 convention.

WORK PARTY at our observatory SATURDAY, APRIL 18th
Director Halbach and Asst. director Schaefer expect a big turnout on this day from our entire membership this time. A strip of land must be readied for the tree-planting project; the bldgs. must be painted inside; trash to be picked up and burned; Bill Albrecht wants an assistant to help on the shutter of the Armfield dome; a few strong backs with the addition of some shovels are needed to move ground from the debris left from the well-digging; also bring paint brushes, rags, cleaning materials like brooms and buckets. Oh yes, Mrs. K. will serve refreshments at noon. We plan some pickup points for those who want a ride out with someone.

The lunar occultation predictions listed below and submitted by T. Dettmann are given for the benefit of those members who would like to participate in this particular phase of astronomy. This work can be done in your own yard, not necessarily at the observatory. More details on this will be supplied at the April meeting.

1964	H	M	S	Z.O.	Mag	Phen	Age	P.A.
Apr. 17	2	56	48.0	911	6.3	Im	4.6	136
19	2	11	12.0	1215	6.8	Im	6.6	103
19	4	24	12.0	1224	5.4	Im	6.6	156
21	2	18	42.0	1462	7.4	graze	8.6	58
21	8	5	24.0	1485	7.2	Im	8.8	91
22	3	46	0	1578	6.8	Im	9.6	150
29	6	59	30.0	2353	4.6	Im	16.8	284
May 14	2	3	30.0	843	7.2	Im	2.2	98
17	2	26	42.0	1315	6.9	Im	5.2	90
19	3	2	36.0	1553	7.5	Im	7.2	170
20	2	5	48.0	1659	6.8	Im	8.2	101
23	3	49	18.0	1976	6.9	Im	11.2	123

For sale: 8" tel. mirror; grinding materials, \$15
T. Dettmann, 2101 S. 88; LI 1-1386

* * *

May 1964



THE DOUBLE DOME

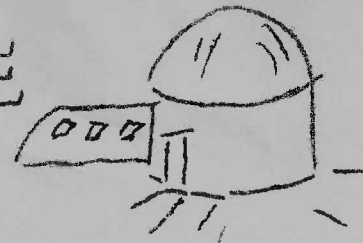

Issued by the

MILWAUKEE ASTRONOMICAL SOCIETY

Friday, May 15, 1964 we will meet in the cafeteria of the new museum. Use the Wells St. entrance. Take the escalator to the lower floor. 7:45 P.M.

Our May gatherings are dull business affairs and too many of our members show their indifference by not showing up. Please try to attend, at least for part of the meeting, this time. We must elect four directors. The nominating committee (Messrs. Brichta, Dahlberg, Glaser) will submit candidates; nominations may also be made from the floor. If we have time, Mr. Albrecht will show an old eclipse film of an expedition some of our members took in Africa. .

Fifteen reservations were sent in to the Racine convention for May 16th. Anyone who wishes to can still send in \$1.50 fee to the Racine Astronomical society and mail it to Mr. O.L. Maves, 3023 21st St. Racine, 53403. The banquet is \$2.50.

We will want to discuss our summer program of open house nights at the observatory. Mr. Ralph Brichta has agreed, once more, to handle this. He looks for help from our members. It should not be too difficult for more of us to offer at least one evening this summer. Please offer him whatever time you are able to spare for this work, either at the meeting or else send him a card.

Mr. & Mrs. Walter Zinn have presented the society with a 4" Criterion reflecting telescope which is to be made available for those of our members who have a program of work they wish to pursue. Our board of directors wishes to publicly thank Mr. & Mrs. Zinn for their generosity. Our members will be grateful and will appreciate very much having another instrument available for their use.

Al Schmidt has a 3" refl. telescope and also a 2", with eyepieces, etc. \$15. His address 2370 S. 78 St. LI-1-2117.

At our last work party we succeeded in planting 800 red pines along the perimeter of the observatory property. Mr. Klann has reported that the installation of an electric pump and water supply system has been contracted for and that this will probably be ready for use by the time our next work party is at hand.

* * *

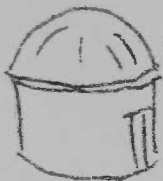

THE DOUBLE DOME

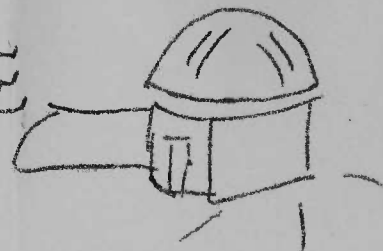

SPECIAL

A STAR PARTY is planned for Saturday, June 13 for all MAS members and their families. Observatory grounds will be opened at 7 P.M. Please come, and bring your telescopes, binoculars, and cameras, so that we can all enjoy looking at the stars together. If it is cloudy or raining, COME ANYWAY! The observatory staff will then conduct an open discussion meeting on the use of telescopes, on astronomical photography, and on other subjects of interest to us all.

OBSERVATORY OPEN HOUSES

All MAS members are invited to participate in this program. There will be opportunities for every one to man the instruments, lecture, and act as guides. There will be special sign-up cards at the observatory at the star party night, and the picnic date. If you cannot be present on either date call Ralph or Shirley Brichta, HO3-9262 to let us know of your choice of date.

PICNIC - JUNE 21

Our picnic is an informal affair - come when you can and bring your supper with you. There will be soda and coffee available. Come and spend a pleasant Sunday afternoon on the hill.

Our new president, Phil Glaser, would like to see all our members get together and learn by doing things together. He hopes to get some planned activities under way. Harry Pease, our new vice president, will plan some programs for our meetings.

Mr. Glaser announced the following committee appointments:

- Ralph Brichta, 1965 League convention chairman and
Observatory open house chairman
- Wm. Albrecht, chairman, observatory building plans.
- E. Halbach, observatory director of programs, special
studies, issuance of keys
- Harry Pease, chairman summer activities; speakers and
arranging of programs
- Len Schaefer, chairman of visitors arrangements during
fall and winter months and assistant
observatory director
- Stephen Kliman, chairman, finance problems and public
relations.

Newly elected directors: W.G. Binn, Wm. Konig, R. Fink, S. Kliman

MARK THESE DATES: JUNE 13th and 21st

Sept 1964



THE DOUBLE DOME

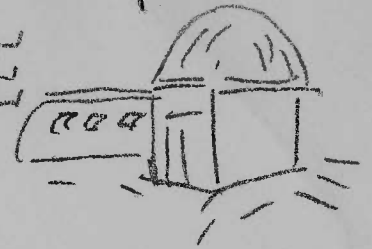

Issued by the

MILWAUKEE ASTRONOMICAL SOCIETY

First meeting of the fall season:

MONDAY, September 21st, 1964 in the NEW Museum building,
(Use Wells St. entrance)

Doors open at 7:30 P.M.

Museum guards will point the way to the lecture room.

The program will include:

A Ranger satellite's view of the moon; slides which Harry Pease made from pictures distributed at a NASA press conference in Washington, D. C., and:

Short reports on Phil Glaser's Jupiter observing;
Ray Ball's way of observing variable stars;
Dick Wend's telescope building; and
Construction progress at our observatory.

* : Star Party : *

A star party for members and guests is set for OCTOBER 3rd
Mark this Saturday night on your calendar!

: Work Party :

Saturday, Sept. 26 the interior of the lecture room must be painted. If you want to help, bring brush, rags, and can or bucket; also have some other odd jobs that need doing.

Treasurer Ball will accept dues for the coming year before and after the Sept. 21st monthly meeting at the museum. He also reports that SPACE SCIENCE is no longer available as a separate publication. It is now a part of Review of Popular Astronomy.

Some of you may wish to accept the attached invitation from the Wis. section of the American Institute of Aeronautics and Astronautics to attend a lecture on the nature of the lunar surface by Dr. John F. McCauley.

* * *

Oct 1964



THE DOUBLE DONE

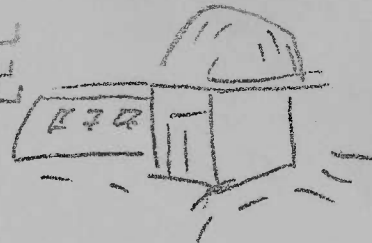

Issued by the

MILWAUKEE ASTRONOMICAL SOCIETY

MONDAY, October 19, 1964, in the New Mussum will be the second meeting of the fall season.
(Use Wells St. entrance; 7:30 P.M.)

The Program

Our main speaker, Tom Pope, a professional photographer, will talk on some material from a five-part paper which he and another of our members, Tom Osypowski, prepared and submitted to SKY and TELESCOPE. This paper deals with the proper requirements for high resolution lunar and planetary photography. Both men have made slides (using the 12-inch at our observatory) which will be used to illustrate the talk.

As a second feature, a camera hobbyist, Hassi Pestalozzi, will show pictures of the 200-inch Hale telescope and the 48-inch Schmidt camera at Mt. Palomar Observatory, and also pictures of galaxies and other deep-sky objects made with the Schmidt camera.

This program will be of some help to those people who want to begin in this field. Advanced amateurs can also expect to get something out of it, too, for refinements of film selection and processing will be discussed.

* * *

Our treasury, Mr. A.R. Ball, will be on hand to accept dues for this year. See him before or after the meeting.

For Sale: 2.4" Uni tron, 2-mos. old. \$115. Michael J. Marinello
2319 W. Finn Pl. Milw. 6; phone 871-6130

* * *

Nov 1964

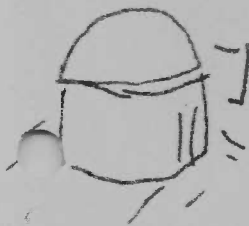

THE DOUBLE DONE

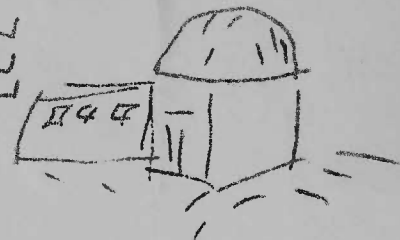

Issued by the
MILWAUKEE ASTRONOMICAL SOCIETY

Meeting

MONDAY, November 16, 1964 in the new museum (use Wells St.
Time: 7:45 P.M. entrance)

The purpose and prospects for the orbiting astronomical observatory, which is to be launched from Cape Kennedy next year, will be discussed by Assoc. Prof. Theo. E. Houck who directs the University of Wisconsin space astronomy laboratory,

(unless, of course, tests of the ultra-violet satellite take him out of town - in which case - he will send us another spokesman)

A movie on the construction and functioning of this satellite will be shown. This observatory is designed to make ultra violet observations of stars.

* * *

For sale: 6" reflector telescope, elec. clock drive, extras; tripod. Call Mrs. Lillian Carus, 2326 S. 79 St. LI-1-1024.

Directors are reminded of a board meeting at the observatory on Saturday the 14th, at 7:30 P.M.

* * *

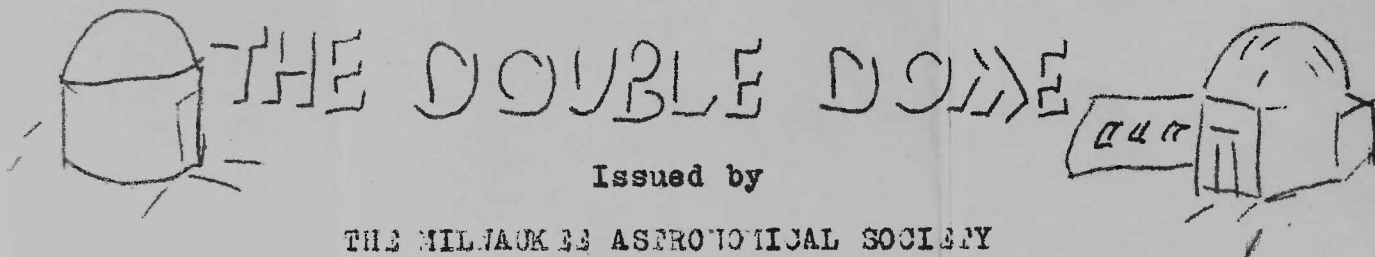

Issued by

THE MILWAUKEE ASTRONOMICAL SOCIETY

The University of Wisconsin-Milwaukee has provided our society with a meeting place for our December 11th 1964 meeting. We would like to express our appreciation to Dr. Shurman for his efforts on our behalf.

So - please mark Friday, December 11, 1964 for the next MAS program. One of our members, Harvey J. Lindemann, has made arrangements for us to see a 28-minute color movie "Eclipse of the Quiet Sun" which depicts 44 minutes of totality photographed during the July 1962 solar eclipse from a DC8 jet aircraft flying over the United States, Canada, France, and Italy. The film is provided by Douglas Aircraft.

Those members who requested a copy of the 1965 Planetary Phenomena can pick it up in:

University of Wisconsin-Milwaukee
Bolton Hall, Room 52
(Map of campus enclosed)

Members are invited to park their cars in any of the University's lots where they can find space. Parking facilities are not strained on Friday nights.

Each year, for many years, one of our members, Herbert W. Cornell, has painstakingly prepared a bulletin of astronomical phenomena observable at Milwaukee, for the use of amateur astronomers. The public museum makes copies of it and includes it in a packet along with a star study and maps. This is on sale (25¢) at the checkroom of the old museum bldg.

The building committee reports that the new construction at our observatory, for which we raised funds last fall, is about ninety per cent complete. New sanitary facilities are installed, and the lecture room enlarged. The "new look" should encourage more members to spend more time there on some of the observing programs.

* * *

The Board of Directors wishes to extend to all our members the

SEASON'S GREETINGS AND WISHES FOR A
SUCCESSFUL NEW YEAR

* * *